

HOBIE BRAVO

REPLACEMENT HULL - 90010000

Handle '08 71190021
Handle 71190011
Screw 8030201 (2)

Decals -
12450015 "Curtis" Set
12450016 "Bravo" Each



Fwd Hatch 8" 71702011
Fwd Hatch Gasket 71331001
Screws 8031130

Rear Hatch 6" 71701011
Rear Gasket 71320001
Screw 8030261

Drain Plug w/ gasket
10091000 (2)
EZ LOC Rudder Pintles
Upper Pintle 90880211
Lower Pintle 90880221
Pintles: (For Aluminum
Castings / Pre-March 2004)
Upper Pintle 90880111
Lower Pintle 38101401
Long Loc Screw 8030411

Righting Line Block
Cheek Block H233
Screws 8030071

RUDDER ASSEMBLY - EZ LOC

90312000

Tiller Extension 90550011 Grip 3206

Tiller Hinge 10532010
Screw 8032061
Nut 8050101
Hinge Yoke 3205
End Cap 90560041
Screw 8031191
Washer 8080561

Tiller Arm 90382011
Rudder Linkage 50313201
Tube Rivet 50313301

Mainsheet Bracket 90700201
Screw 8030981
Nut 8050211
Upper Bolt 8040391
Nut 8050331

EZ LOC Housing 50313001
Detent Plunger 20492021
Retainer Clip 90880231
Bungee (3/16" x 10") RS316BLK
Lower Bolt 8040321
Washer 8080671
Nut 8050331

Up-Lock pin kit
50314001

EZ LOC
Rudder Blade
20491000

RUDDER ASSEMBLY

(PRE-"EZ LOC" RUDDER SYSTEM)
3/04 - Serial 6129

Tiller Extension 90550001 End Cap 10560000

Tiller Connector Cap
90560020
Tendon 37561011
Screw 8030701 (2)
Tiller End Cap
37561001

QR PIN
8020141
Upper Casting
50311031
Lower Casting
50322001
Cam
10480000

Rudder Bushing
Upper 8062001
Lower 38360001
Bolt 8040331
Nut 8050311

Rudder Blade
20493000

Bravo Mast Float w/Straps and Buckles

90600012 UNIVERSAL



Nylon "Saddle" Strap 90600021 (2 Per)
Screw 8030071 (4 Per)
Attachment Web Strap
W/ Buckle 90600041 (2 Per)

MAST

Comptip
90611001

Lower Mast
90613000
(Fits newer boats serial
663-Higher) Older boats
require modified step assy
#90172011

Eyelet Posts (2)
41220001

Mast Collars (3)
90610101

Delrin Balls (48)
90610111

Mast Bearing
90612111

Furler Line
90610121

Mast Base
90640011

Screw 8031151

SAIL

Bravo Sail
9099XXXX

Sail Bag
90992000

Mast/Sail Bag
90991000

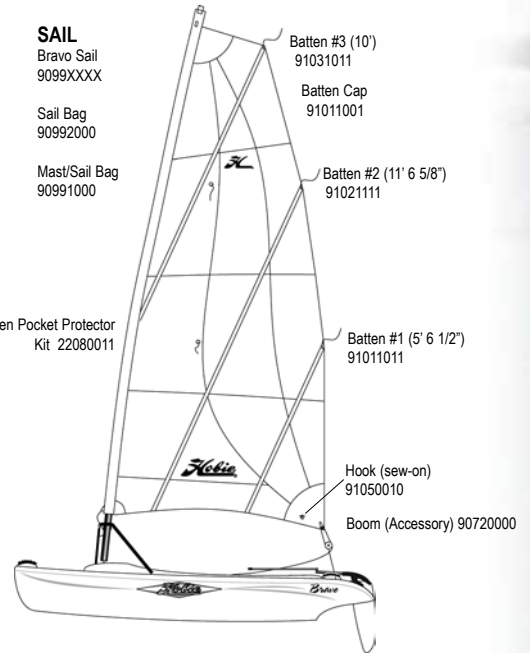

Batten #3 (10')
91031011

Batten Cap
91011001

Batten #2 (11' 6 5/8")
91021111

Batten #1 (5' 6 1/2")
91011011

Hook (sew-on)
91050010

Boom (Accessory) 90720000

Luff Batten Pocket Protector
Kit 22080011

A-FRAME

2 Pc A-frame 90701001*

Mast Keeper Knob 90502031

Screw
8030361

Padeye 71220001
Camcleat 37380001

Hinge/Gate Assy
Original Style 90500021
Screw 8031130

Newer Gate design is not
designed as an upgrade

Cover Plate
90700050
SCREW
8031130

*A-Frame Attachment Kit

Serial 0001-0501
Part #90711001

Serial 0502-Current
Part #90711011

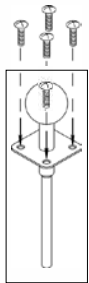

MAST STEP ASSY

Mast Step Assy 90170011
(Serial 663-NEWER)

Mast Step Assy 90170001
(Serial 662-OLDER)

Screws
8032011
Mast Ball
90640021

BRAVO RIVET GUIDE

() Indicates quantity need to fasten part

Mast

Comptip Notch 8010181(1)
Collars 8010131 (4/collar)
Eyelet Posts 8011231 (1/post)

A-Frame

Gate Hinge 8012062 (1)
Padeye 8010131 (2)
Cam Cleat 8010131 (2)

Vertical Support Tube

Base 8010181 (4)
Webbing Strap 8010181 (2)
A-frame Connector 8010131 (2)

Rudder

Upper Casting 8010131 (3)
Tiller End Cap 8010131 (2)
Bravo Extension Cap 8010181 (1)

Boom

End Cap 57130000(2)
Boom Cap Casting 8010131 (2)
Padeyes 8010131 (2/padeye)
Cam Cleat 8010131 (2)

RIGHTING LINE



Single Block 90440050

Righting Line
RL012BLU (10' 9")

Bungee Cord
RS014BLK (7)

Cheek Block H233

Mainsheet Line
RM516BLU (28 1/2')

Pre-EZ LOC

Nut 8050111
Low Pro Nut
8050101

Older Cable
Mainsheet
attachment
assembly
90700011

Lower Block
With Post
90700131
CAM CLEAT
RF5011 CAM CLEAT
RF5015 FAIRLEAD
8030241 SCREW (2)