

HOBIE 18 / 18 SX

Decals -
 12451130 "Hobie" Red Each
 12451021 "Hobie" Diamond 36" Red
 12452000 Silver pin stripe (ft)

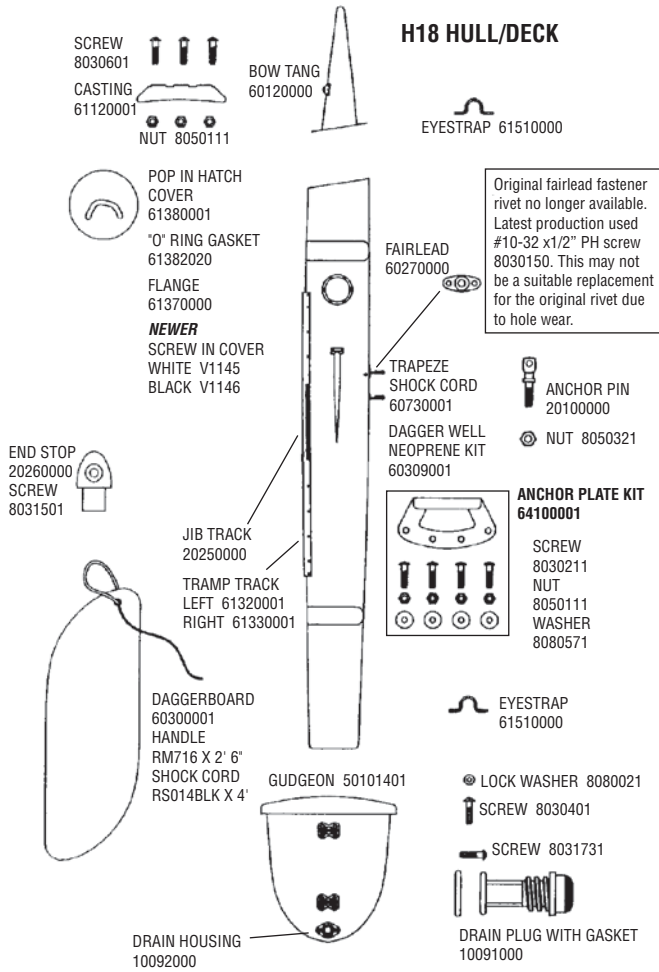

H18 TRAMPOLINE

COMPLETE TRAMPOLINE 6097XXXX
 (XXXX = Color / See parts list for available options)
 (Does not include lace line)

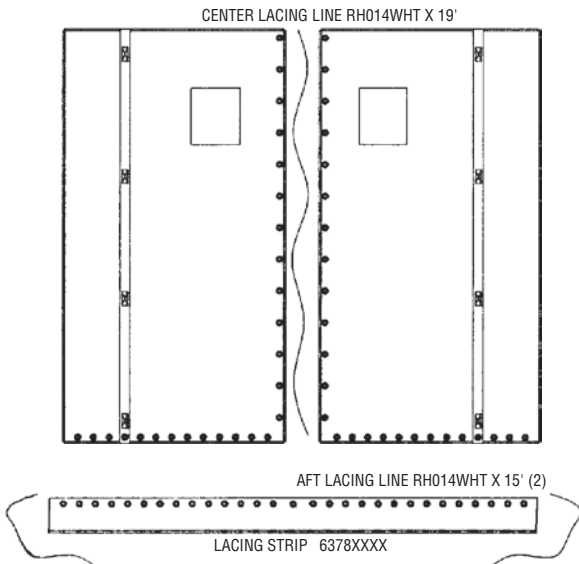

H18 FWD CROSSBAR

CROSSBAR WITH STEP CASTING BLACK 60132010

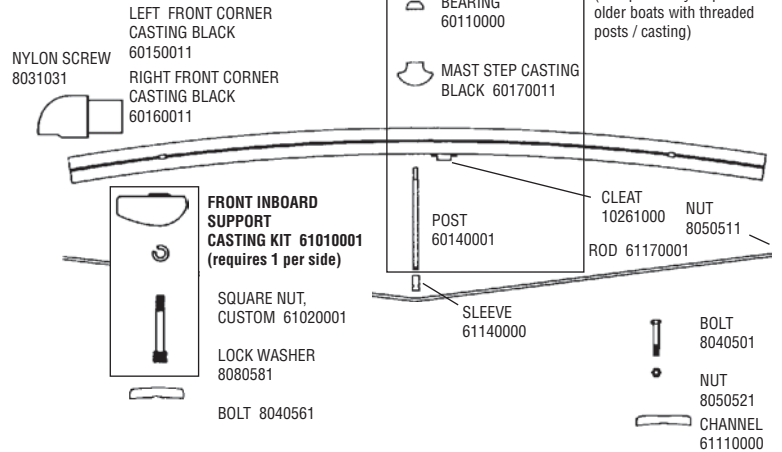

H18 REAR CROSSBAR

REAR CROSSBAR - EXTRUSION ONLY BLACK 60191211

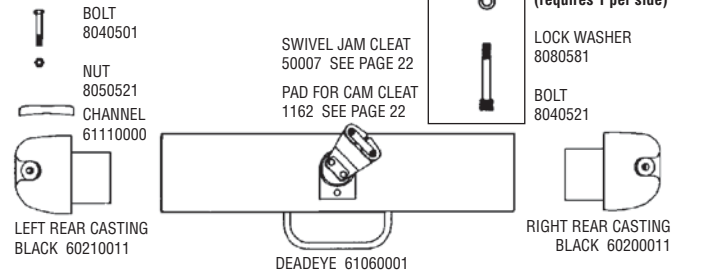

H18 MAIN TRAVELER CAR

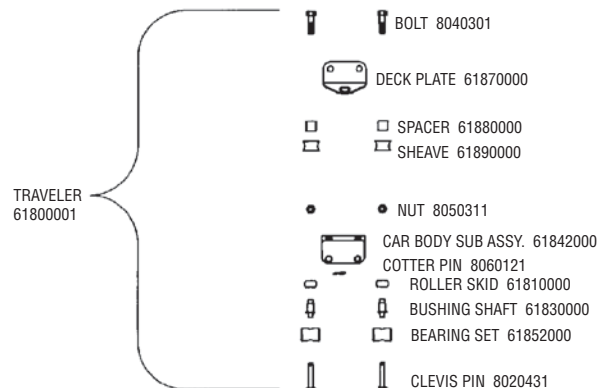

H18 / H18SXRUDDER ASSEMBLY

* = SUB ASSEMBLY PART / INCLUDED WITH CASTING

UPPER CASTING
1987 AND LATER
LEFT BLACK 50321001
RIGHT BLACK 50341001

*BOLT
8040301
*WASHER
8080181

1986 AND EARLIER

60331010 CONVERSION KIT REQUIRED
INCLUDES: UPPER CASTING ASSEMBLIES, TUBE,
END CAP, LOWER CASTING ASSEMBLIES, NUTS,
BOLTS, GUDGEONS. FOR BOTH SIDES.

1987 AND LATER
TILLER TUBE, STRAIGHT
60380111

END CAP
10400010

*CAM PLATE 20352000

1987 AND LATER
*CAM 10480000

*PIN 50312301

TILLER CONNECTOR KIT
11520005

BOLT
8040331

NUT
8050311

PLASTIC RUDDER
BLADE 20493000

EPO2 BLADE
CARBON 20490020

LOWER CASTING
1987 AND LATER
BLACK 50322001

NYLINER 8061011

COTTER PIN
8060111

RUDDER PIN
60880001

*ADJUSTMENT
SCREW
8032001

1986 AND EARLIER
PLUNGER - NONE

1987 AND LATER
*PLUNGER 50312200

SPRING 60430000

*SPRING 10430000

TENSION SCREW
60450000

*TENSION SCREW 60450000

H18 / H18SX TILLER CROSSBAR & EXTENSION

TILLER CROSSBAR

BLACK 20520011

'95 - NEWER 20521001

YOKE ASSY. 3205

RING 20860000

CLEVIS PIN 8020411

RUDDER ADJUSTER KIT
60400011
SCREW 8030701
NUT 8050111

FIBERGLASS EXTENSION (106") WITH HINGE 60550001

HINGE 10532010
SCREW 8030111
NUT 8050201

EXTENSION TIP
10560000

H18 / H18SX MAST

18 MAST ASSY. BLACK 60610010

18SX MAST ASSY. BLACK 68581000

COMPTIP ASSEMBLY 60611100

MAST HEAD ASSY.
COMPTIP
60602041

SHEAVE 60620000

RIVET 8010151

HALYARD
LOCK
(COMP TIP)
61610101

LUFF TRACK UPDATE 50404101
LUFF TRACK 38584001

HALYARD LINE RH014WHT'
SE x 58' SX x 61'

CAP PLUG
8090900

RING 61290021
TWIST SHACKLE 60670000

MAST TANG
20690000

SX REACHER TANG 30691001

DIAMOND TANG
61480000

DANGER!
ALWAYS USE EXTREME
CAUTION WHILE RAISING
AND LOWERING YOUR MAST.
CONTACT WITH A POWER
LINE COULD BE FATAL.

SAIL FEEDER KIT
80100501

SPREADER TANG
61410000

DANGER LABEL
13440010

COMPRESSION PLATE KIT
60680001

SLEEVE
61490000

GOOSENECK
60710000

FOAM PLUG 60060000

SEAL PLATE 61080000

MAST BASE
BLACK 60641031

PIN 8020501

HINGE BLACK
60650011

DOWNHAUL LINE
RH316WHT X 7'

BLOCK
11400000

CLEAT
10262000

CLEVIS PIN 8020381

RING 20860000

VERTEX 50772031

BOLT 8040021

NUT 8050111

SHEAVE
60620000

CLEVIS PIN
8020391

RING
20860000

CLEVIS PIN 8020431

RING 20860000

H18 / H18SX DIAMOND WIRES

18 DIAMOND WIRE 61750001

18SX DIAMOND WIRE
68750001

COTTER PIN 8060111

CLEVIS PIN 8020021

ROLLER
61740000

TURNBUCKLE 61770000

H18 / H18SX SPREADERS

SLIDE
61440000

COTTER PIN
8060111

COTTER PIN
8060001

COTTER PIN
8060001

CLEVIS PIN
8020041

CLEVIS PIN
8020061

BRACE
61430000

ARM
61420000

COTTER PIN
8060001

COTTER PIN
8060001

CLEVIS PIN
8020041

CLEVIS PIN
8020061

SPREADER TANG
61410000

CLEVIS PIN
8020061

CLEVIS PIN
8020041

CLEVIS PIN
8020061

COTTER PIN
8060001

COTTER PIN
8060001

BRACE
61430000

ARM
61420000

CLEVIS PIN
8020041

CLEVIS PIN
8020061

COTTER PIN
8060001

COTTER PIN
8060001

SLIDE
61440000

COTTER PIN
8060111

H18 / H18SX ROTATION ARM

ROTATION BAR 61210001

BOLT 8040111

NUT 8050111

WASHERS 8080571

LINE RH316WHT X 3'

H18 / H18SX FORESTAY & JIB HALYARD

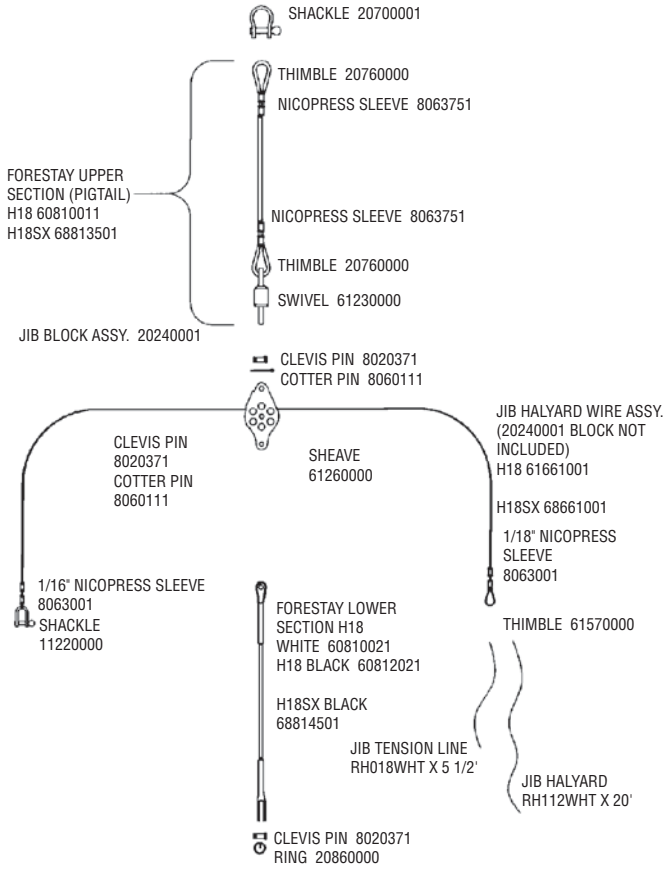

H18 / H18SX SHROUDS & ADJUSTERS

H18 SHROUD (1 SIDE)
WHITE 60790001
BLACK 60792001

H18SX SHROUD (1 SIDE) SHACKLE 20700001
BLACK 68793501

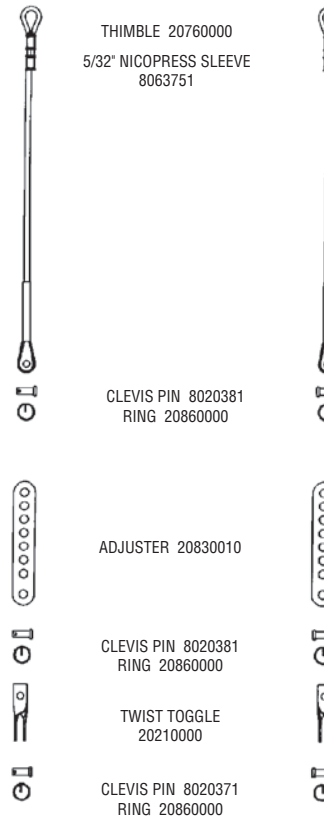

H18 RIVET GUIDE

() Indicates quantity needed to fasten part.

MAST	
HEAD	8010131 (2)
HALYARD HOOK	8011231 (6)
TANG	8010181 (12)
DIAMOND TANG	8010181 (3)
SPREADER TANG	8010181 (8)
COMPRESSION PLATE	8010181 (4)
GOOSENECK PLATE	8010181 (4)
GOOSENECK CLEAR	8010131 (2)
GOOSENECK BLOCK	8010131 (2)
BASE	8010131 (2)
(Note: all 8010181 mast rivets require 08011291 rivet caps)	

REAR CROSSBAR	
CORNER CASTING	8011231 (6)
INBOARD SUPPORT	8010131 (2)
SWIVEL JAMMER	8010201 (1)
	8031501 (2)
	8031231 (1)
	8080011 (1)
	8050801 (1)
DEAD EYE	8010181 (4)

HULL	
TRAMPOLINE TRACK	8010121 (9)
(backup washers required on above, 8080551)	
ACCESS PORT FLANGE	8010141 (12)
EYE STRAP	8010131 (2)

BOOM	
END CAP	8010131 (2)

FRONT CROSSBAR	
MAST STEP	8010131 (4)
INBOARD SUPPORT	8010131 (2)
JAM CLEAT	8010181 (2)

RUDDER (UPPER CASTING)	
CASTING	8011231 (3)
END CAP	8010131 (2)

SAIL HARDWARE	
HEADBOARD	8010020 (16)
MAIN CLEW PLATE	8010020 (10)
BATTEN POCKET	8010020 (4)
JIB CLEW PLATE	8010020 (6)
(above rivets requires setting machine which is not available in a hand tool.)	

H18 / H18SX ROLLER FURLER

FURLER TUNE UP KIT 61900900
INCLUDES: BEARINGS, BEARING CAGE, NYLINER, NYLON SLEEVE, DARBY RINGS, SPOOL, HOUSING

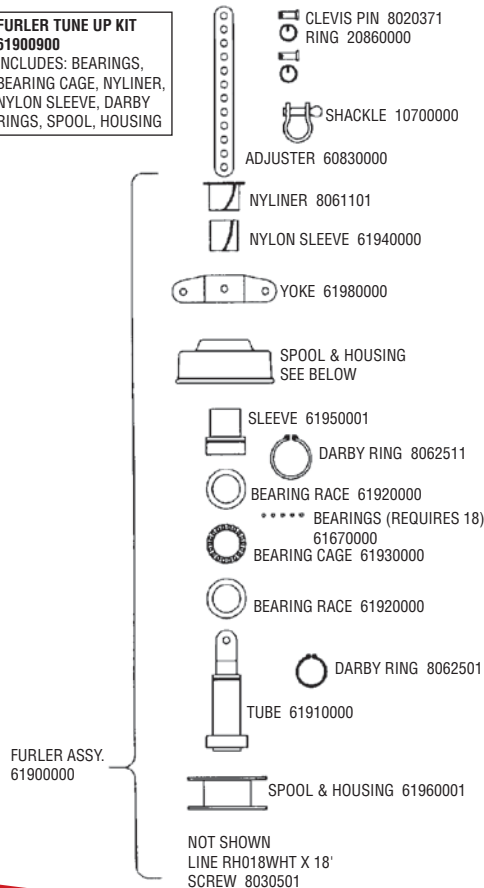

H18 / H18SX TRAPEZE WIRES

H18 WHITE 1473W (One Side Pair)
H18 BLACK 1473B (One Side Pair)

H18SX BLACK 68503501 (Single)

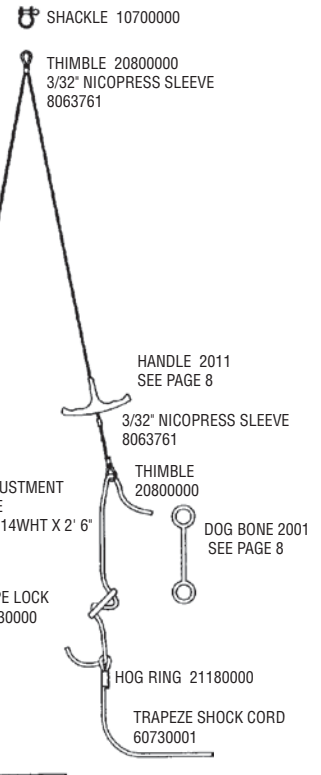

H18 / H18SX BRIDLES

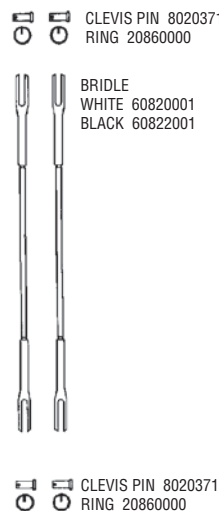

H18 MAIN SAIL & BATTENS

H18 60991XXX / H18SX 68991XXX
SEE NUMERICAL SECTION

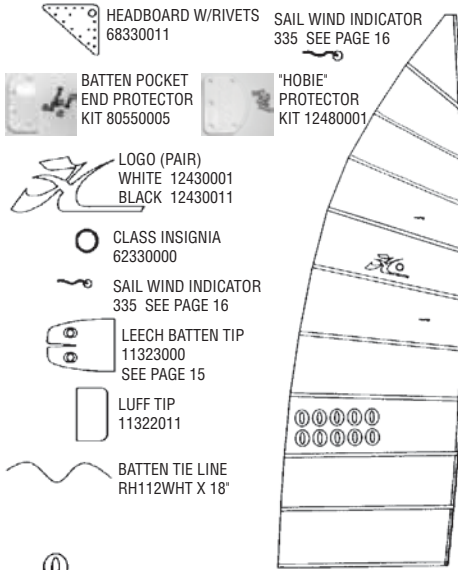

JIB SAIL

H18 60992XXX
H18SX 68992XXX

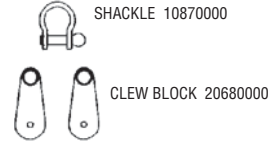
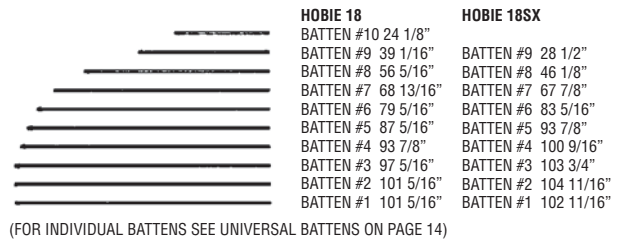
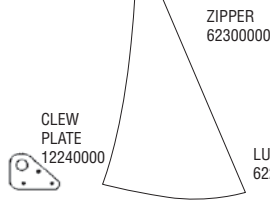

H18 / H18SX BOOM

BOOM ASSEMBLY BLACK
60720011

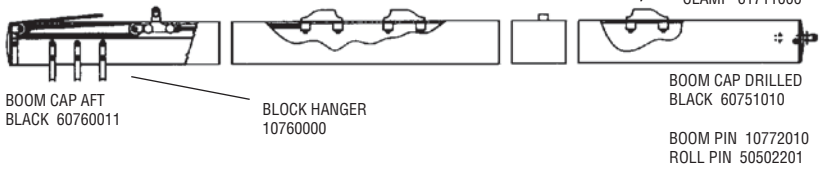

OUTHHAUL CAR ASSY 60220001 (OUTHHAUL AND SHOCK CORD NOT INCLUDED)

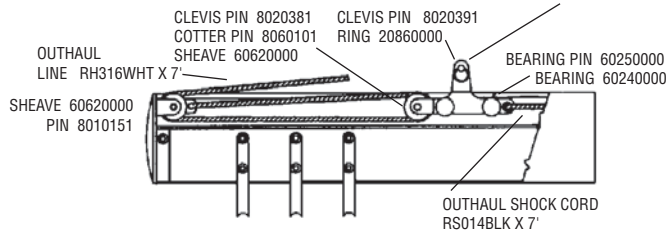

SX18 WINGS

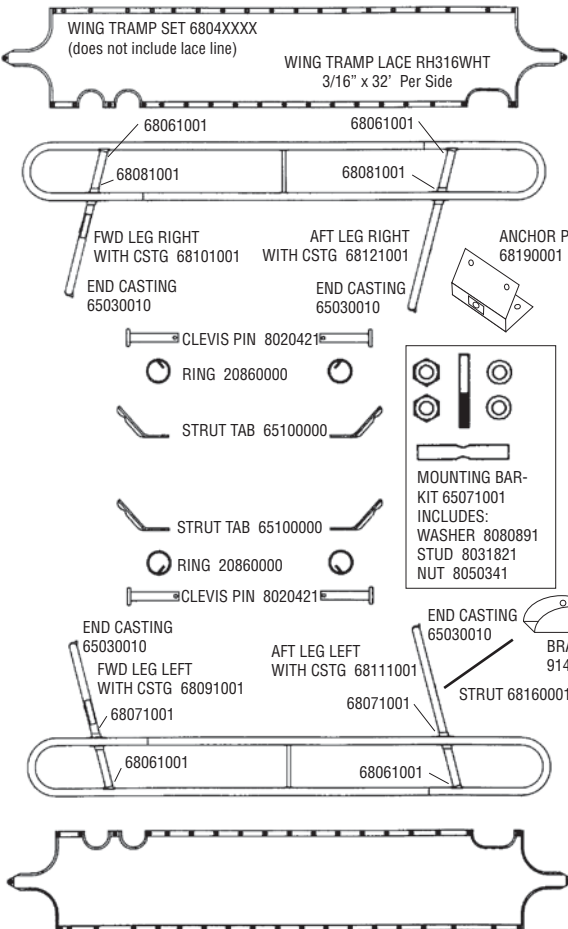

SX WINGS PARTS KIT 68060101
(EVERYTHING EXCEPT WINGS, TRAMPS, LINES AND EXTENSION)

CLEVIS PIN 8020061
RING 10860001

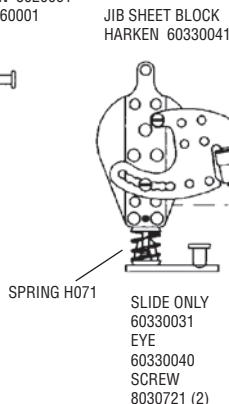

H18 BLOCK SET WITH LINE

