

HOBIE MIRAGEDRIVE V2

WHAT MAKES A V2 Drive? V2 Drums, V2 Chains, V2 Idler Cable and V2 (Threaded) masts / sprockets
(USED IN 2009 PRODUCTION AND NEWER)

- 80010001 MIRAGEDRIVE V2
- 80013011 MIRAGEDRIVE I-SERIES V2
- 80013001 MIRAGEDRIVE ST TURBO V2
- 81222001 PEDAL/CRANK ASSY. (R)
- 81221001 PEDAL/CRANK ASSY. (L)
- 81222101 CAP - PEDAL CRANK
- 81222011 PEDAL ONLY (R)
- 81221011 PEDAL ONLY (L)
- 81226001 PEDAL STRAP (R)
- 81227001 PEDAL STRAP (L)

- 81203001 IDLER CABLE V2 (18.5")
- 8050111 NUT
- 81121001 IDLER PULLEY
- 53170020 SET SCREW
- 81110001 PULLEY SHAFT

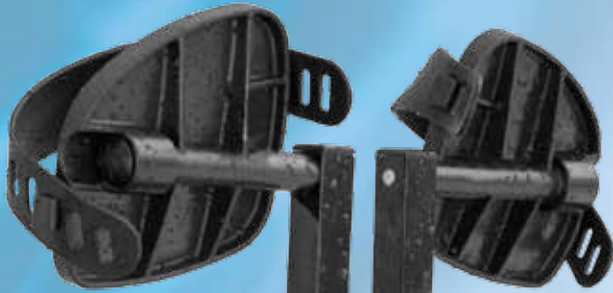
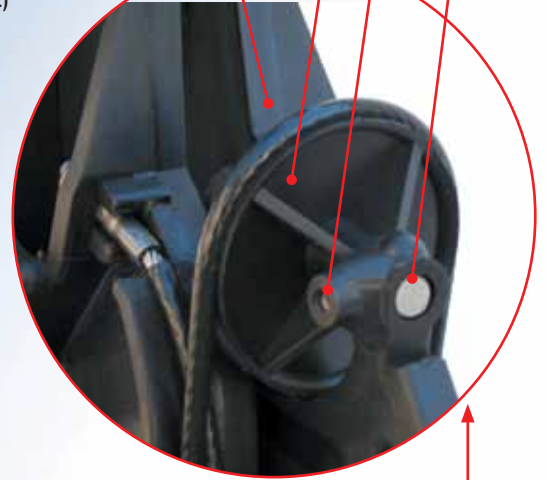

72020034 PEDAL PAD KIT



81172001 PEDAL ADJUSTMENT DECAL

- 81236001 PEDAL ADJ ASSY
INCLUDES:
81240001 PLASTIC HANDLE
- 81230001 PIN
- 8031201 SCREW
- 81242001 SPRING
- 8034071 ALLEN WRENCH



- DRIVE SEAL
- 81037001 STD
- 81038001 i - Series
- 8031581 SCREW
- 8080461 WASHER

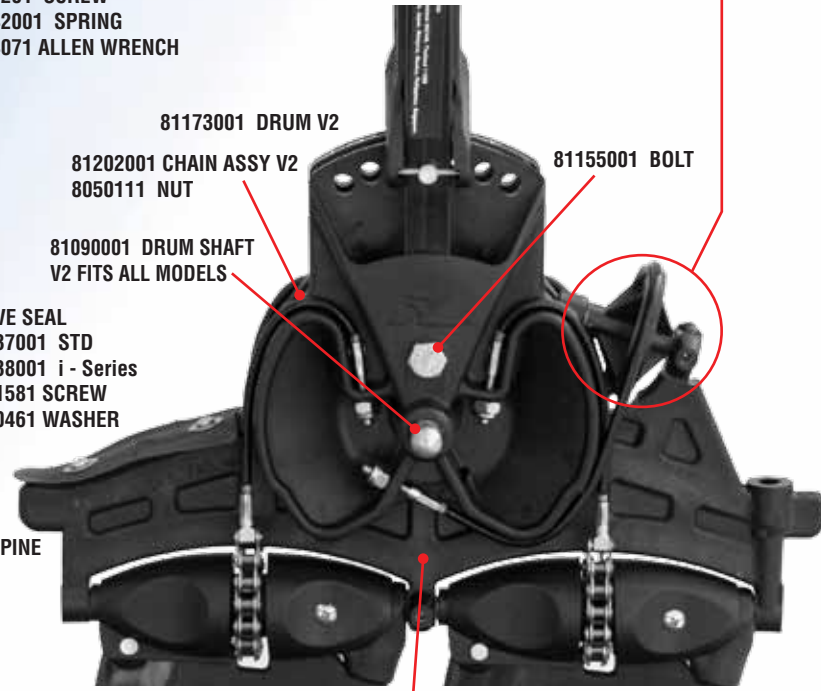

- 81173001 DRUM V2
- 81202001 CHAIN ASSY V2
- 8050111 NUT
- 81155001 BOLT
- 81090001 DRUM SHAFT
V2 FITS ALL MODELS

81181001 SPINE

- 81080001 SPROCKET SHAFT
- 53170020 SET SCREW

81095001 DRIVE ALIGNMENT PIN 2012+

- 81050001 OUTHAUL BLOCK
- 8020041 CLEVIS PIN
- 10860001 LOCK RING
- 81055001 SPROCKET GUARD FWD
- 8031451 SCREW



- 81190001 STANDARD FIN
- 81193001 ST FIN
- 81192001 ST TURBO FIN

- 81129001 SPROCKET
V2 THREADED
W/ FWD GUARD



- 81163001 MAST V2 THREADED
- 81198101 MAST / ST TURBO V2 THREADED
- 8000341 LOC-TITE .5ML

V2 SPROCKET UPDATE KIT
(2 V2 SPROCKETS AND 2 V2 MASTS)
81129022 V2 STANDARD MAST KIT
81129122 V2 TURBO MAST KIT

HOBIE MIRAGEDRIVE "V1"

Drive with older plastic drum, plastic spine, Sprocket / mast connection is a set-screw



HOBIE MIRAGEDRIVE OLDER

Original drive with aluminum spine, stainless sprocket / mast connection is cotter key.

- 81130001 SPROCKET (STAINLESS)
- 81340001 SPROCKET BUSHING (SS SPKT)
- 81420001 SPROCKET GUARD
- 8060111 COTTER KEY (MAST / SS SPKT)
- 81040001 OUTHAUL BLOCK (SS SPKT)
- 8020061 CLEVIS PIN
- 10860001 LOCK RING
- 81211001 IDLER CABLE 14 3/4" (SOLID PULLEY)
- 81150001 DRUM BUSHING (ALUM DRUM)
- 81105001 CRANK ARM RIGHT, THREADED
- 81100001 CRANK ARM LEFT, THREADED

RUDDER SYSTEMS

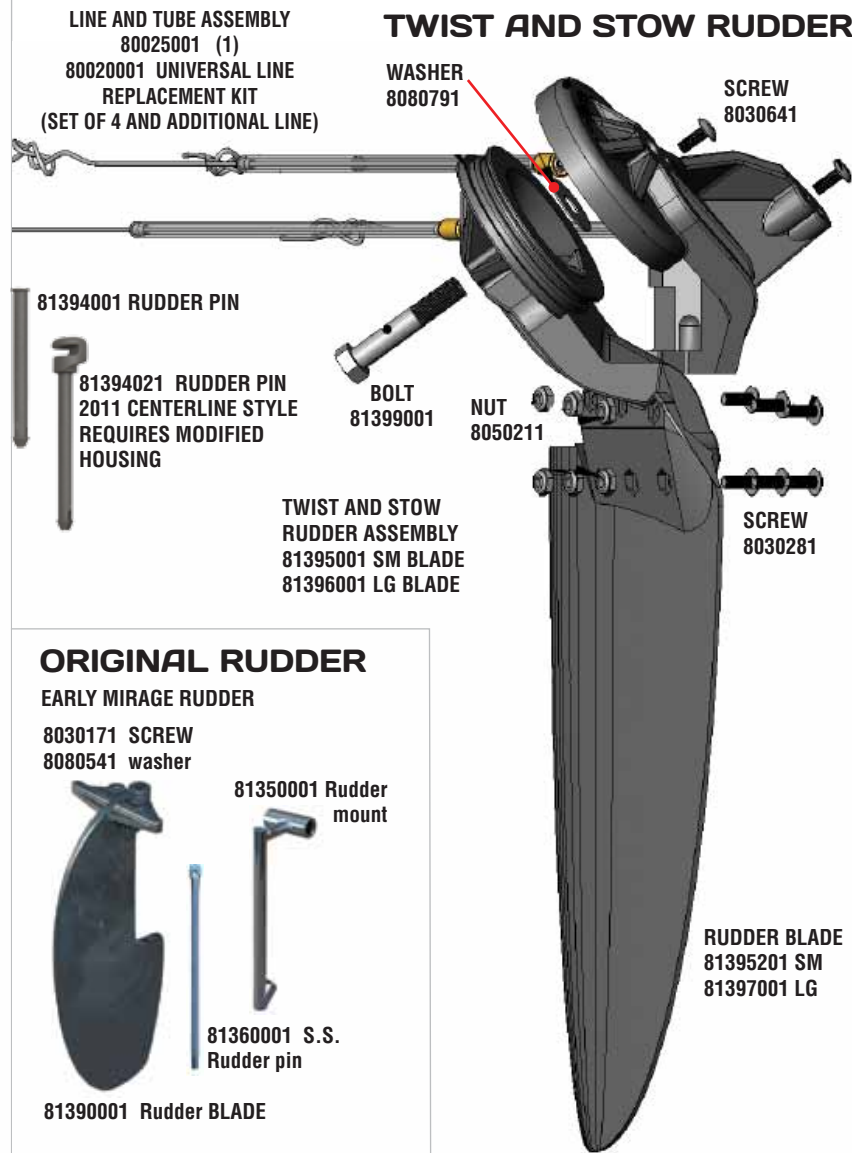

ORIGINAL RUDDER

EARLY MIRAGE RUDDER

- 8030171 SCREW
- 8080541 washer



MIRAGEDRIVE SPARE PARTS KITS

Spare parts kits include a spare fin, mast, sprocket, chain, clevis pin and ring. All in a handy zippered pouch. Available for the standard fin drives or drives with ST Turbo fins. Standard kit shown.

MIRAGEDRIVE V2 (THREADED MAST STYLE)

Includes parts listed above for V2 "threaded mast" drives.

- 80010301 KIT V2 Standard FIN
- 80013301 KIT V2 Turbo FIN

MIRAGEDRIVE OLDER (SET SCREW MAST STYLE)

Includes parts listed above plus: Set screw, allen wrench, and a cotter key.

- 80010201 KIT Standard FINS
- 80013201 KIT Turbo FINS

TECH TIP

MAINTENANCE AND TUNING - Maintenance and tuning information for MirageDrives and Twist and Stow rudder systems is available on the Hobie Cat website support area. <http://www.hobiecat.com/support/history/>

Direct link to the support pages for kayaks is here: <http://www.hobiecat.com/support/products/kayaks/>

PERFORMANCE FINS ST or ST TURBO!

ST FINS ...and you thought the Hobie MirageDrive was the most amazing propulsion system ever seen! Now you can make your Hobie MirageDrive a **SUPER PERFORMER!**

Hobie Mirage kayak users report as much as 10% increase in speed and more using ST TURBO Fins. But its not all about speed, you can get top end speed and a slower cadence for cruising (Less pedals per mile). All achieved with these larger and more efficient fin designs. Increase your performance or increase your fitness routine, you choose the fin that is right for you: Standard, ST or ST Turbo... low, medium or a higher gear! The standard fins, supplied with our kayaks, are the easiest pedaling fins, but some users feel that the standard fins do not offer enough resistance. This is very evident when using our sailing kits. The added power and speed of the sail often outpaces the standard fins (similar to pedaling a bike down hill in first gear). Want to go really fast? Add the ST TURBOs for sailing! The longer fins can also increase lateral resistance for sailing upwind.

These ST (Square Tip) designs will require a bit more effort to pedal. The added effort is commonly compared to pedaling a bike up a slight incline. In addition, the included fin tension screw allows adjustment to achieve lower end torque or top end speed to meet the desires of the pedaler.

ST Fins fit any Hobie MirageDrive. If you prefer the ST fin, order 2 per drive. The ST TURBO fins require longer masts. The ST TURBO fin kit comes with 2 fins, 2 masts and all needed fittings (available for V1 or V2 drives)

- | | | |
|-----------------|--|-----------------|
| 72066001 | ST TURBO Fin Kit V2 (2009 and Newer Threaded Sprocket) | \$95.99 |
| 72065 | ST TURBO Fin Kit (Older SS or Set-screw Sprocket) | \$95.99 |
| 80013001 | MirageDrive with ST Turbo fins Installed | \$540.00 |
| 81193001 | ST Fin / Single (Requires 2 per MirageDrive) | \$26.99 |
| 81192001 | ST TURBO Fin / Single (replacement) | \$29.99 |



ST FIN

ST TURBO
FIN KIT

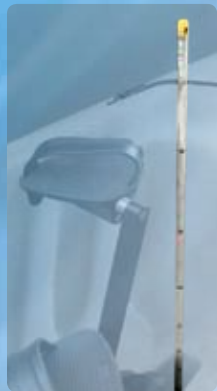

HOBIE MIRAGE SPEEDO

Removable, "pitot tube" speedometer measures your pedaling speed. Fits current MirageDrive systems only (Plastic spine on drive serial number 16054 and higher).

- 80030001** SPEEDO
\$20.59



MIRAGEDRIVE STOW BAG

Protect your MirageDrive... and other goods in your car from the drive! This heavy duty Cordura and mesh bag fits the complete MirageDrive with standard fins or the ST Turbo length. It has small pockets inside for the speedo tube, scupper plugs or spare parts. Has a carry handle and a shoulder carry strap. There is extra space in the bag for things like a life vest or drive well plug. Also includes "D" ring fittings to allow attachment to Inflatable rolling bags. Large enough to store your Inflatable's drive, pump and 4 piece paddle.

- 80024** MIRAGEDRIVE BAG **\$47.99**



PEDAL PAD KIT

Softer on your feet! Neoprene pads are self adhesive and stick right to your pedals. Stock on Drives built in 2010+

- 72020034** PEDAL PAD KIT BLACK (PAIR)
\$6.99



DRIVE WELL SEAL

Keeps the seat area drier. Seals the aft end of the MirageDrive well. Limits the incursion of water into the cockpit caused by the surge action of the drive fins. Testers also claim some improvement of forward thrust. Easily attaches to any MirageDrive. Kit includes one seal and two attachment "zip ties".

- 81037001** Well Seal **\$10.99**
81038001 i - Well Seal **\$10.99**



LEASH KIT - MIRAGEDRIVE If you ever remove your MirageDrive while on the water... protect your investment from an accidental drop overboard. Includes hardware for attachment to the hull.

- 74052101** LEASH KIT - MIRAGEDRIVE **\$17.49**



SIDEKICK AMA KIT

Whether you are a pro or a novice, you will enjoy the sense of security from the extra amount of stability offered by the SideKick ama kit. Great for use when sailing, fishing, standing when site fishing, shooting photos! The SideKick ama kit is simple, light weight and effective!

The SideKick's cross arms adjust the float height with a simple "click-twist-click". Just like a paddle shaft adjustment. Three positions offer you high - medium - low positions. Set the floats high for cruising (less drag) or secondary stability. Use the medium or low settings for primary stability (less initial roll). Fine adjustments for float height are done by twisting the main crossbar within its mounts and tensioning with the fastening hardware.

Set up and use right off the beach or disassemble and deflate to store inside the hull. Then assemble and inflate when you get to your dive or fishing spot. Inflation is simple. Just blow a few breaths into each float through their one-way valves. Valve cap unscrews for rapid deflation. Installs with 4 bolts using expanding nuts.

- 72062101** SIDEKICK AMA KIT - Light Gray **\$164.00**
- 72063101** SIDEKICK AMA KIT - Dark Green **\$164.00**
- 72062061** SIDEKICK +07 ADVENTURE MOUNTING ADAP PLATE SET **\$17.00**
- 72062062** SIDEKICK - MOUNT KIT W/CENTER BAR **\$37.00**

SIDEKICK AMA KIT Extra stability for your kayak. Fits most Hobie models and most other kayaks. Whether you sail, fish, shoot pictures, dive or just want to feel a bit more stable when using your kayak, the SIDEKICK AMA KIT will do it. Light weight and simple to install. The floats are inflatable.



MIRAGE SEAT PAD - INFLATABLE "I-COMFORT"

Adjustable comfort! Replaces the standard foam seat pad for the Hobie Mirage. Adjust the cushion by adding or releasing air pressure. Like an inflatable camping pad. Has an internal self inflating foam and an air valve through which the pad can be further inflated / deflated to suit the users comfort. Not designed for use on Hobie Mirage Inflatable kayaks. Can be used in combination (stacked) on the standard seat cushion.

- 72020028** MIRAGE SEAT PAD - INFLATABLE "i-Comfort" **\$44.99**



MIRAGEDRIVE SPARE PARTS KITS

Spare parts kits include a fin, mast, sprocket, chain and appropriate parts for the drive version. Older drives have sprockets and masts that use a set screw connection. V2 drives use threaded sprockets and masts. All in a handy zippered pouch. Don't waste a day on the water when your MirageDrive could be easily repaired. Available for the standard fin drive or a drive with the ST Turbo fins. Standard kit shown.

- 80010201** Standard (Set Screw Sprocket) **\$106.00**
- 80013201** Turbo (Set Screw Sprocket) **\$119.00**
- 80010301** V2 Standard (Threaded Sprocket) **\$106.00**
- 80013301** V2 Turbo (Threaded Sprocket) **\$119.00**



STEERING KNOB ASSY

Get a grip on your steering. More comfortable hand position - better leverage. Knob only, fits all 2011+ Mirage model steering handles and all Tandem Islands. Includes knob, cap and attachment bolt.

- 88991355** KNOB ASSY **\$8.99**



PADDLE "T" HANDLE

Convert your kayak paddle to a canoe style paddle. Easier to store on many models of Hobie Mirage kayaks where paddle use is unnecessary while using the MirageDrive. Plugs into the female half of the kayak paddle.

- 74049001** PADDLE "T" HANDLE **\$11.99**